

# KBC10 PTZ CAMERA CONTROLLER

Joystick and button easy to operate  
Multi-camera control solution



Multiple Control  
Network Protocol



LCD Real-time  
Display



Joystick  
Precise Control



Button  
Easy Setup



Support  
PoE



Up to connect  
255 cameras

## >>> FEATURES

- Supports multiple control and network protocol, compatible with any PTZ cameras
- LED screen real-time display working status, improve efficiency
- Reasonable button layout, easily handle any live video production.
- 4D Joystick precise speed control
- Custom button setting, more flexible for controlling
- Multiple control connectors, up to connect 255 cameras
- Supports POE (Power over Ethernet)

## >>> 4D JOYSTICK



## >>> PACKING LIST



Controller



Power Adapter



User Manual

## >> CONNECTING



Switcher



PTZ Camera

255



PTZ Camera

The controller and PTZ camera must be connected to the same LAN, and IP addresses must be at the same segment.

## >> PARAMETERS

Description	PTZ Camera Controller		
Model No.	KBC10		
Connectors	Communication	RS232	1 × DB15
		RS422 (RS485)	1 × 5 Pin Terminal
		LAN	1 × RJ45
Performance	Control Protocol	VISCA   Pelco-D   Pelco-P	
	Network Protocol	ONVIF   VISCA	
	Baud Rate(dps)	2400   4800   9600   19200   38400   115200	
	Display	LCD Screen	
	Key Tone	ON/OFF	
	Joystick	Four dimensions (control: up, down, left, right, zoom, rotation)	
	Upgrade	WEB upgrade	
Input Voltage	DC 12V		
Max Power	0.6W		
Temperature	0°C~50°C		
Humidity	0%~90%		
Unit Weight	1.69kg		
Unit Size	320 × 180mm × 100mm		

# >> STRUCTURE

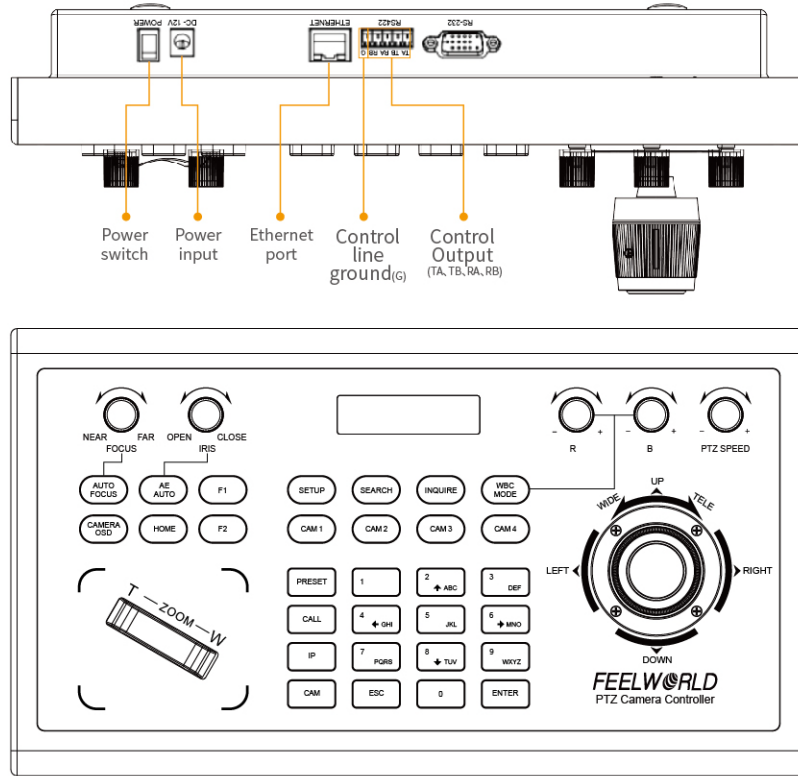

- 【AUTO FOCUS】** Auto Focus button: Set the camera in auto focus mode with this button. It will light up when camera is in manual focus mode.
- 【AE AUTO】** Auto Aperture button: Set the camera in automatic aperture mode with this button. It will light up when camera is in manual aperture mode.
- 【CAMERA OSD】** Camera OSD button: call/close the camera OSD.
- 【HOME】** HOME button: The camera will back to home position if camera OSD is off. While when the camera OSD is called out, the home button is confirm function of camera OSD.
- 【F1】 ~ 【F2】** Custom function buttons: Custom functions in VISCA and IP VISCA modes.
- 【SETUP】** Controller local Settings button: Modify and view local settings.
- 【SEARCH】** Search button: Search for all available devices with ONVIF protocol in the LAN (only in ONVIF Mode)
- 【INQUIRE】** Inquire button: Check added devices
- 【WBC MODE】** Auto white balance button: Set the camera in auto white balance mode. It will light up when camera is in manual white balance mode.
- 【CAM1】 ~ 【CAM4】** Quickly switch device button: Quickly switch to CAM NUM 1-4 devices (ONVIF, IP VISCA), or to address code 1-4 devices (VISCA, PELCO)
- 【PRESET】** Short press to set presets; long press to delete presets setting. It needs to work with the number keys and “enter” button, for setting or deleting presets.
- 【CALL】** Call preset button: It needs to work with the number keys and ENTER button.
- 【IP】** Manually add network device button: Manually add network devices (only in ONVIF and IP VISCA modes)
- 【CAM】** In IP VISCA and ONVIF modes, it will quickly switch to the CAM NUM bound device when adding a device via CAM. In VISCA and PELCO modes, it will switch to the address code when entering a certain address. It needs to work with the number keys and “enter” button.
- 【1】 ~ 【9】** Number keys of 0, 1,2,3,4,5,6,7,8,9. 2,4,6,8 serve as direction keys as well, which could control pan and tilt rotation, and camera OSD.
- 【ESC】** Return
- 【ENTER】** Confirm Button
- 【NEAR】 【FAR】** Manually adjust the focal length.
- 【OPEN】 【CLOSE】** Manually adjust the aperture, OPEN(Aperture Plus)/CLOSE(Aperture minus)
- 【R-】 【R】** Manually adjust the Red Gain
- 【B-】 【B+】** Manually adjust the Blue Gain
- 【PTZ SPEED-】 【PTZ SPEED+】** Adjust PTZ Speed, Gears 1 (Slow)- 8(Fast)